

# CUBIC



# CUBIC

## about cubic

Cubic offers a clean, smooth look ideal for use in the retail, office or leisure interior.

Cast joints facilitate the connection of stainless steel sections to produce a wide variety of display units and furniture.

All components are finished to compliment the satin polished stainless steel box-section.

Special items and sizes on request

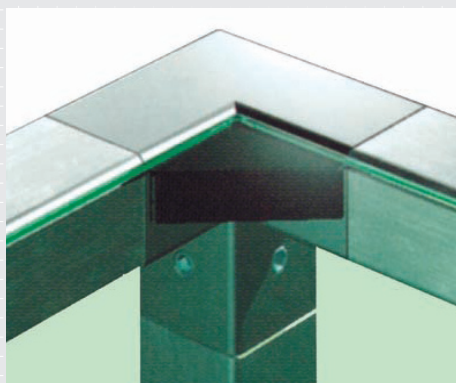

## assembly details

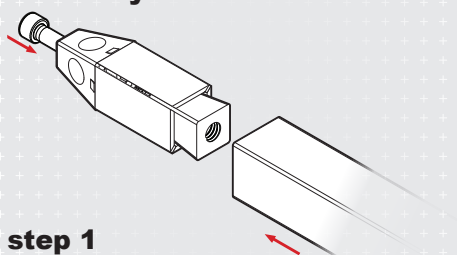

### step 1

Wedge assembly is placed inside the box section.

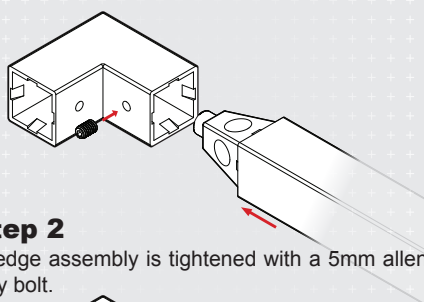

### step 2

Wedge assembly is tightened with a 5mm allen key bolt.

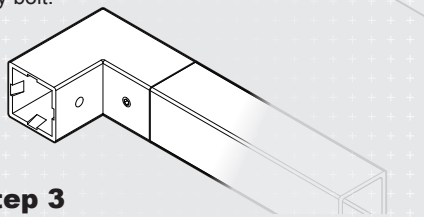

### step 3

Wedge assembly is placed into joints and clamped with grub screw using 2.5mm Allen key.

## cubic joints

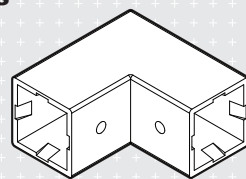

**code: 4000**

2-way flat joint

**code: 4001**

2-way flat joint - with M10 threaded hole

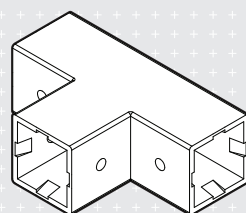

**code: 4002**

3-way flat joint

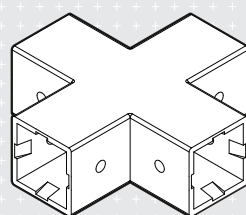

**code: 4003**

4-way flat joint

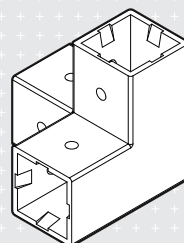

**code: 4004**

3-way corner joint

**code: 4005**

3-way corner joint - with M10 threaded hole

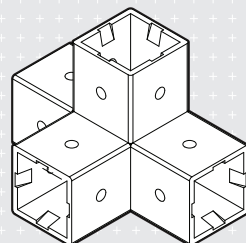

**code: 4006**

4-way corner joint

stock items marked:

all dimensions in mm

all sizes nominal



A full range of accessories are available for timber or glass tops and doors as well as castors, feet, ticket holders and illumination.

## display table

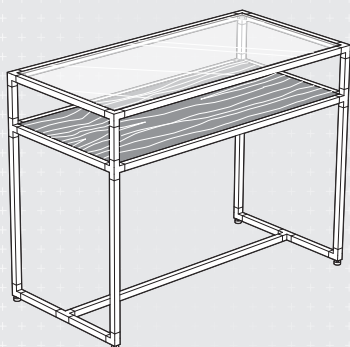

**code: cu-40**

sizes: 1200 x 600 x 900

finish: stainless steel, glass top, shelf available in various finishes

## mannequin bases

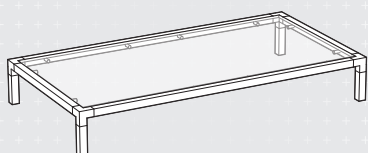

**code: cu-45**

Sizes: 1100 x 550 x 150

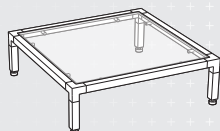

**code: cu-50**

Sizes: 550 x 550 x 150

Finish: stainless steel, top available in various finishes.

## wall unit

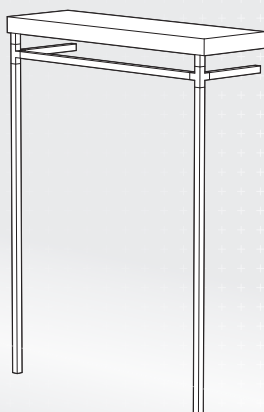

**available to order**

Sizes: hanging height according to merchandise  
finish: stainless steel cubic frame. shelf available in various finishes. optional lighting

## gondola unit

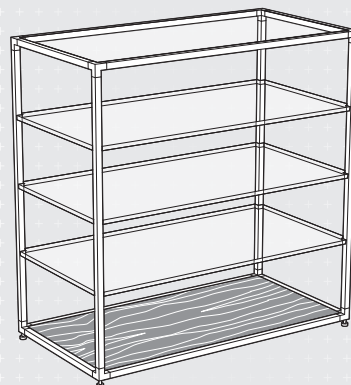

**code: cu-55**

Sizes: 1200 x 1200 x 600

1500 x 1200 x 600

1800 x 1200 x 600

Finish: Stainless steel frame, shelves available in various finishes.

## showcases

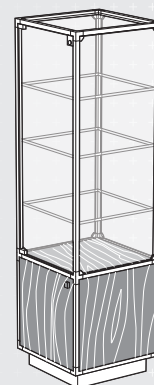
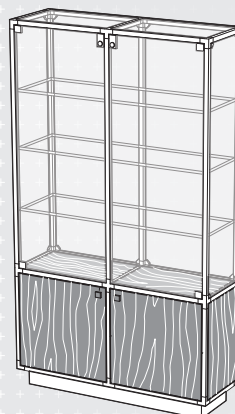

**available to order**

Finish: Panels available in various finishes.

Stainless steel, glass and timber. lighting option



## centre floor units

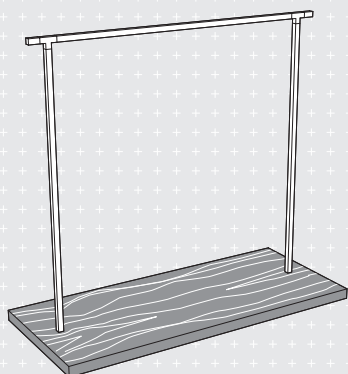

### code: cu-10

Sizes: 1500 x 650 x 1365

Finish: Stainless steel frame, base available in a variety of finishes.

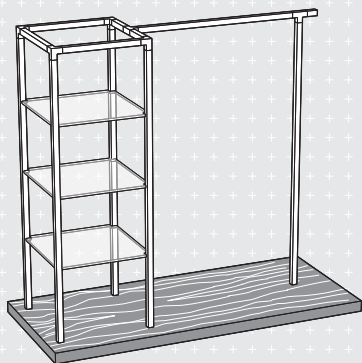

### code: cu-20

Sizes: base: 650 x 1500

Cube: 450 x 450, overall height: 1365

Finish: Stainless steel frame, base and shelves available in a variety of finishes.

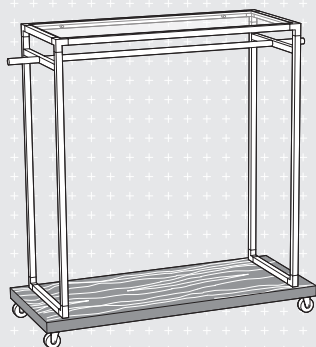

### code: cu-35

Sizes: base: 1200 x 500 x 45

Overall: 1000 x 350 x 1100

Finish: Stainless steel frame, base and shelves available in a variety of finishes.

